

## SERVICE INFORMATION LETTER (SIL)

### Overhaul Recommendations Carleton P/N 2239 Series Crew Oxygen Regulator / Refill Valve

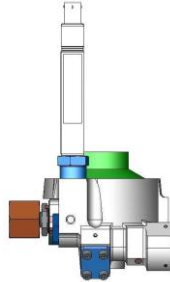

**OXYGEN – ATA CHAPTER 35**

**CAGE CODE: 04577**

This Service Information Letter was released by Carleton Technologies Inc. to assist customers who have previously requested information on ways to reduce unscheduled removals while providing the ability to forecast repairs and related maintenance expenses.

The overhaul recommendations listed in this SIL are provided by Carleton Technologies Inc. in an effort to assist owners and operators of aircraft with 2239 Series Crew Oxygen Regulator / Refill Valves installed.

#### **A. SUBJECT**

This SIL recommends an overhaul frequency for the 2239 Series Crew Oxygen Regulator/Refill Valve and includes information about an overhaul kit available from Carleton Technologies Inc. The overhaul kit contains the minimum recommended replacement parts Carleton typically recommends for replacement during overhaul.

Additionally, this SIL provides information about function testing requirements after an overhaul, however does not supercede Test Fault Isolation procedures found in the appropriate Component Maintenance Manual (CMM). Refer to section C of this SIL to determine the appropriate CMM for affected top assembly part numbers.

#### **B. APPLICABILITY**

This SIL is applicable to all aircraft where the 2239 Series Crew Oxygen Regulator/Refill Valve is installed, especially certain series of DC-10, MD-10, MD-11 and 767 model aircraft.

2239 Series Crew Oxygen Regulator/Refill Valve part numbers affected by this SIL are:

2239-0001-1

2239-0001-3

2239-0001-5

**C. REFERENCES**

Service and overhaul of a 2239 Series Crew Oxygen Regulator/Refill Valve must be done in accordance with the applicable ATA Component Maintenance Manual issued by Carleton Technologies Inc. Refer to the table below to identify which CMM to use for a particular top assembly part number.

Carleton Top Assembly PN	Applicable ATA CMM	CMM Rev. No. / Rev. Date
2239-0001-1	35-12-01	Rev. 7 / June 15, 2007
2239-0001-3	35-12-01	Rev. 7 / June 15, 2007
2239-0001-5	35-12-03	Rev. 1 / Nov. 7, 2007

**D. RECOMMENDED ACTIONS**

1. **Overhaul Frequency** - Perform an overhaul every five years for the 2239-0001 Series Crew Oxygen Regulator/Refill Valve. An overhaul frequency less than 5 years may be necessary due to prolonged service, contamination or severe in-service conditions.
2. **Parts Replacement** – Use Overhaul Kit P/N 2239-9001-1. The overhaul kit contains the minimum recommended replacement parts for an overhaul of the 2239-0001 Series Crew Oxygen Regulator/Refill Valve.

Refer to Table 1 in this SIL for a complete list of parts contained in Overhaul Kit P/N 2239-9001-1. Refer to the appropriate CMM for information about parts contained in the kit that may require replacement during overhaul or other maintenance operations.

3. **Functional Testing** – Functional Testing must be completed in accordance with the applicable CMM after an overhaul on the 2239-0001 Series Crew Oxygen Regulator/Refill Valve.

**E. INSTRUCTIONS**

- Use the appropriate CMM and overhaul kit part number information contained in this SIL to do an overhaul of the 2239 Series Crew Oxygen Regulator/Refill Valve.
- Any overhaul performed on this apparatus shall be done by those facilities experienced in, or by personnel knowledgeable in high pressure aviation oxygen equipment. Contact Carleton Technologies for information regarding getting a regulator overhauled at Carleton’s facilities. See Paragraph G for information on how to contact Carleton Technologies, Inc.

TABLE 1  
PARTS CONTAINED IN OVERHAUL KIT P/N 2239-9001-1

IPL ITEM NUMBER	PART NUMBER	DESCRIPTION	QUANTITY
10	2239-0020-903	Seal Ring	1
15, 280, 420	1030-0012-45	Lock Plug	6
25	2236-0020-904	Seal Ring	1
35	2239-0020-011	Seal Ring	1
40	2239-0036-011	Back-up Ring	1
45	2239-0072-1	Anti-rotation Ring	1
55	2239-0074-1	Filter Retainer	1
60	1014-0001-001F	Inlet Filter	1
65	2239-0074-3	Filter Retainer	1
75	2239-0020-907	Seal Ring	1
80, 95, 140	1030-0012-44	Lock Plug	7
100	2239-0039-1	Filter Retainer	1
105	1014-0001-001A	Filter	1
125	2239-0036-012	Back-up Ring	2
130, 325	2239-0020-012	Seal Ring	2
195	2239-0036-010	Back-up Ring	1
200	2239-0020-010	Seal Ring	2
205	2239-0015-1	Orifice Filter Assy.	1
220, 255, 435, 455, 540	1030-0012-23	Lock Plug	10
290	2279-501-004-1	Seal Ring	1
295	2239-0034-1	Back-up Ring	1
300	2239-0020-014	Seal Ring	1
305	2239-0035-1	Back-up Ring	1
320	2239-0024-1	Orifice Seat	1
350	1030-0012-42	Lock Plug	2
385	2239-0020-023	Seal	1
395	2239-0036-018	Back-up Ring	1
400	2239-0020-18	Seal	1
405	2239-0089-1	Poppet Assy.	1
410	2239-0091-1	Seal Ring	1

TABLE 1 (cont.)  
PARTS CONTAINED IN OVERHAUL KIT P/N 2239-9001-1

IPL ITEM NUMBER	PART NUMBER	DESCRIPTION	QUANTITY
415	2239-0082-1	Filter Assy.	1
475, 520	1030-0012-43	Lock Plug	4
495	2239-0055-1	Separator	1
510	2239-0020-016	Seal	1
515	2239-0020-008	Seal	1
525	2239-0020-041	Seal	1
545	2239-0020-015	Seal Ring	1
550	2239-0036-015	Back-up Ring	1
555	2239-0110-1	Anti-Friction Ring	1
580	2239-0060-1	Plug Assy.	1
590	2239-0058-1	Orifice Seat	1
595	2239-0020-013	Seal Ring	1
605	2239-0111-1	Anti-Friction Ring	1

**F. WARRANTY INFORMATION**

Carleton warranty remedies are not applicable to the subject(s) covered in this SIL.

**G. CONTACT CARLETON TECHNOLOGIES:**

- A. To get a 2239 Series Crew Oxygen Regulator/Refill Valve overhauled, contact Carleton at +1 (716) 662-0006 or [www.carltech.com](http://www.carltech.com).
- B. To buy overhaul kits or parts, contact Carleton at +1 (716) 662-0006 or [www.carltech.com](http://www.carltech.com).